

# WAREHOUSE TRUCK

## NEW LINES



TOUGH WORLD. TOUGH EQUIPMENT.

**LiuGong Construction Machinery N.A,LLC.**

22220 Merchants Way - Suite 100

Katy, TX 77449

USA

T: 281-579-8882

F: 281-579-8388

[www.liugong.com](http://www.liugong.com)

Like and follow us:



LIUGONG 082019-ENG

The LiuGong series of logos herein, including but not limited to word marks, device marks, letter of alphabet marks and combination marks, as the registered trademarks of Guangxi LiuGong Group Co., Ltd. are used by Guangxi LiuGong Machinery Co., Ltd. with legal permission, and shall not be used without permission. Specifications and designs are subject to change without notice. Illustrations and pictures may include optional equipment and may not include all standard equipment. Equipment and options varies by regional availability.

TOUGH WORLD. TOUGH EQUIPMENT.





Li-ion Pallet Truck

Main Features



HIGHT PERFORMANC

- Standard lithium battery, maintenace free.
- Hight capacity battery and quickly charger for option.
- Inside BMSCSD battery managerment system for more safety and long life.
- The battery can be charged in working gap without take out for longer woring time.



CONVENIENCE

- Working steady and easy exchange the battery in 5s.
- Curtis controller and CAN-bus system for easy to check.
- The controller have the self-diagnosis function and the error code be show on LCD.
- Every cover can be easy to disassembly.



INTELLIGENT HANDLE

- Can-bus handle with all button to easy touch.
- Coded lock inside for more safety.
- The driving speed can be automatic control with different handle angle.



FLEXIBLE AND DURABLE

- Smaller body can be easy to turnover the container and elevator.
- The handle is upright and can be used for walking in a narrow space.
- Lightweight body and guaranteed strength design, 5% energy saving compared to traditional lead-acid battery models.
- Strong power, hight gradeability.



OPTIONS: Sigle loading wheel & 1070/1220/1525mm height Load Brackets.



SPECIFICATION

|               |  |    |            |                                    |            |                                    |            |
|---------------|--|----|------------|------------------------------------|------------|------------------------------------|------------|
| Specification | Model  | 1  |            | CLG2015L                           |            | CLG2020L                           |            |
|               | Power Type   | 2  |            | Elctric                            |            | Elctric                            |            |
|               | Driving Type   | 3  |            | Walking                            |            | Walking                            |            |
|               | Capacity   | 4  | Q (kg)     | 1500                               |            | 2000                               |            |
|               | Load Center  | 5  | c (mm)     | 600                                |            | 600                                |            |
|               | Overhang   | 6  | x (mm)     | 947                                |            | 951                                |            |
|               | Wheel Base   | 7  | y (mm)     | 1185                               |            | 1189                               |            |
| Weight        | Service Weight                                       | 8  | kg         | 123                                | 126        | 149                                | 153        |
|               | Loading Axle Load, Driving / Loading                 | 9  | kg         | 500 / 1123                         | 626 / 1000 | 621 / 1528                         | 625 / 1528 |
|               | Unloading Axle Load, Driving / Loading               | 10 | kg         | 96 / 27                            | 99 / 27    | 115 / 34                           | 119 / 34   |
| Chassis       | Wheel  | 11 |            | PU                                 |            | PU                                 |            |
|               | Driving Wheel Size                                   | 12 | x w (mm)   | 210×70                             |            | 210×70                             |            |
|               | Loading Wheel Size                                   | 13 | x w (mm)   | 80×93( 80×70)                      |            | 80×93( 80×70)                      |            |
|               | Balance Wheel Size                                   | 14 | x w (mm)   | 80×30                              |            | 80×30                              |            |
|               | Wheels(x= Driving Wheel) Driving / Loading           | 15 |            | 1x/ 2(1x/ 4) or 1x +2/ 2(1x +2/ 4) |            | 1x/ 2(1x/ 4) or 1x +2/ 2(1x +2/ 4) |            |
|               | Driving Tread Width                                  | 16 | b10 (mm)   | -/420                              |            | -/420                              |            |
|               | Loading Tread Width                                  | 17 | b11 (mm)   | 380                                | 525        | 380                                | 525        |
| Dimension     | Lifting Height                                       | 18 | h3 (mm)    | 115                                |            | 115                                |            |
|               | Handle Height, Min / Max                             | 19 | h14 (mm)   | 700 / 1160                         |            | 700 / 1160                         |            |
|               | Fork Height  | 20 | h13 (mm)   | 80                                 |            | 80                                 |            |
|               | Overall Length                                       | 21 | l1 (mm)    | 1530                               |            | 1536                               |            |
|               | Body Length  | 22 | l2 (mm)    | 380                                |            | 386                                |            |
|               | Overall Width  | 23 | b1 (mm)    | 540                                | 685        | 540                                | 685        |
|               | Fork Size  | 24 | s/e/l (mm) | 47 / 160 / 1150                    |            | 47 / 160 / 1150                    |            |
|               | Fork Spread  | 25 | b5 (mm)    | 540                                | 685        | 540                                | 685        |
|               | Min Ground Clearance                                 | 26 | m2 (mm)    | 33                                 |            | 33                                 |            |
|               | Aisle Width, 800x1200 pallet                         | 27 | Ast (mm)   | 2000                               |            | 2006                               |            |
| Performance   | Turning Radius                                       | 28 | Wa (mm)    | 1330                               |            | 1336                               |            |
|               | Driving Speed (load / unload)                        | 29 | km/h       | 4.6/ 4.8                           |            | 4.8/ 5.2                           |            |
|               | Lifting Speed (load / unload)                        | 30 | mm/s       | 20 / 25                            |            | 17 / 22                            |            |
|               | Lower Speed (load / unload)                          | 31 | mm/s       | 50 / 40                            |            | 50 / 30                            |            |
|               | Max. Gradeability (load / unload)                    | 32 | %          | 4 / 16                             |            | 8 / 16                             |            |
| System        | Brake System   | 33 |            | Electromagnetism                   |            | Electromagnetism                   |            |
|               | Driving Motor Power, S2 60min                        | 34 | kW         | 0.65                               |            | 0.75                               |            |
|               | Lifting Motor Power, S3 10%                          | 35 | kW         | 0.50                               |            | 0.80                               |            |
|               | Battery According DIN 43531/ 35/ 36 A, B, C Standard | 36 |            | No                                 |            | No                                 |            |
|               | Battery Voltage, Capacity, K5                        | 37 |            | 24 / 20(24 / 30; 24 / 36)          |            | 48 / 20                            |            |
|               | Battery Weight (+/-5%)                               | 38 | kg         | 4.6                                |            | 7.5                                |            |
|               | Energy Consumption (According VDI)                   | 39 | kWh/h      | 0.18                               |            | 0.25                               |            |
| Others        | Driving Control Type                                 | 40 |            | DC                                 |            | DC                                 |            |
|               | Ear Noise  | 41 | dB(A)      | <70                                |            | <70                                |            |

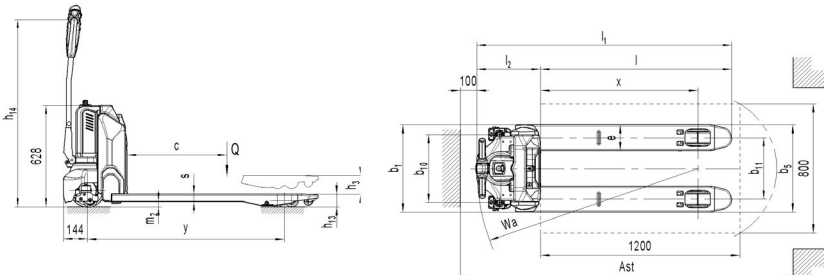



# Electric Pallet Truck

## Main Features



### GERMANY AC DRIVE TECHNOLOGY

- The powerful German Schabmueller maintenance free AC Drive motor in combination with the Greman Kordel gearbox,Intorqe brake and Wicke drive wheel give best performance,efficiency and reliability to reduce the running cost.
- The AC Drive can gives always the right response when gentle or fast acceleration whatever you desired.

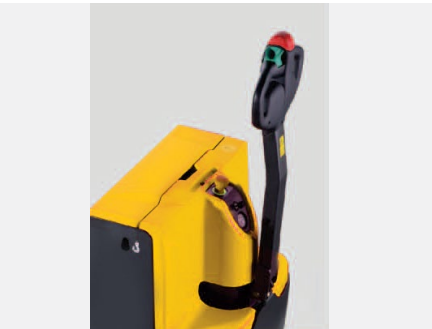

### LONG TILLER DESIGN FOR ERGONOMICS AND SAFETY

- In particular through the long tiller design the operator can always keep a safe distance to the truck during proceeding the work very ergonomically.
- The design ensures lower operational forces than trucks with a short tiller.
- The tillers operating height is naturally positioned to ergonomic,operator friendly controlling positions.



### MAINTENANCE FRIENDLY

- The trucks design and the used components are tailored to make service and maintenance easy.All components are easy to reach when removing the main cover only with 2 screws,drive-and castor wheel are east to exchange without craning the truck.



### LONG LASTING BATTERY

- With the long lasting battery capacities for every model.
- With sideways battery exchange for long operations and multi-shifts.

## SPECIFICATION

| Feature         | Model                          | 1  |      | CLG2016L-WA |     | CLG2020L-WA |     | CLG2025L-WA |     |
|-----------------|--------------------------------|----|------|-------------|-----|-------------|-----|-------------|-----|
|                 | Poer Type                      | 2  |      | Electric    |     | Electric    |     | Electric    |     |
|                 | Driving Type                   | 3  |      | Walking     |     | Walking     |     | Walking     |     |
|                 | Capacity                       | 4  | kg   | 1600        |     | 2000        |     | 2500        |     |
| Dimension       | Overall Length                 | 5  | mm   | 1670        |     | 1735        |     | 1950        |     |
|                 | Overall Wide                   | 6  | mm   | 690         |     | 690         |     | 690         |     |
|                 | Overall Height                 | 7  | mm   | 1335        |     | 1335        |     | 1335        |     |
|                 | Min. Height of Fork            | 8  | mm   | 85          |     | 85          |     | 85          |     |
|                 | Max. Height of Fork            | 9  | mm   | 205         |     | 205         |     | 205         |     |
|                 | Fork                           | 10 | mm   | 1150×173×60 |     |             |     |             |     |
|                 | Fork Spread                    | 11 | mm   | 540         | 685 | 540         | 685 | 540         | 685 |
|                 | Wheel Base                     | 12 | mm   | 1261        |     | 1327        |     | 1541        |     |
|                 | Turning Radius                 | 13 | mm   | 1440        |     | 1490        |     | 1750        |     |
| Performance     | Driving Speed (load / unload)  | 14 | km/h | 5.7 / 6.0   |     | 5.7 / 6.0   |     | 5.5 / 6.0   |     |
|                 | Lifting Speed (load / unload)  | 15 | mm/s | 25 / 35     |     | 22 / 30     |     | 35 / 45     |     |
|                 | Lowering Speed (load / unload) | 16 | mm/s | 35 / 30     |     | 35 / 35     |     | 40 / 40     |     |
| Motor           | Driving Motor Power            | 17 | kw   | 1.3         |     | 1.3         |     | 1.7         |     |
|                 | Lifting Motor Power            | 18 | kw   | 0.8         |     | 0.8         |     | 2.2         |     |
|                 | Battery Capacity / Voltage     | 19 | Ah/v | 160 / 24    |     | 210 / 24    |     | 350 / 24    |     |
| Wheel Dimension | Front Wheel                    | 20 | mm   | Φ84×84      |     |             |     |             |     |
|                 | Balance Wheel                  | 21 | mm   | Φ100×40     |     |             |     |             |     |
|                 | Driving Wheel                  | 22 | mm   | Φ230×70     |     |             |     |             |     |
| Weight          | Service Weight                 | 23 | kg   | 445         |     | 535         |     | 720         |     |
|                 | Battery                        | 24 | kg   | 150         |     | 215         |     | 285         |     |

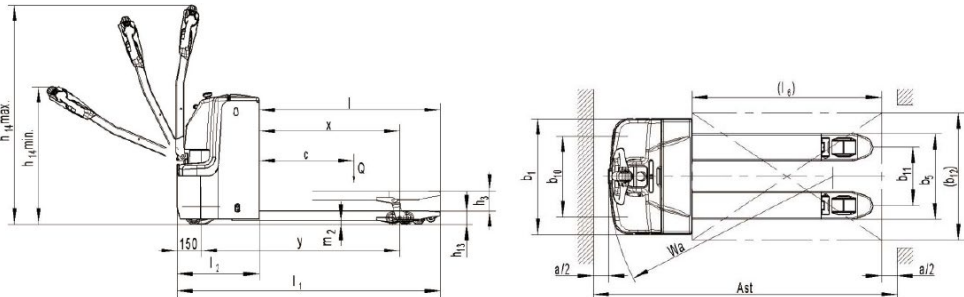





# Electric Pallet Truck

## Main Features



### ROOMY PLATFORM

- The roomy platform ensures operator comfort throughout the day.



### BACKREST

- Heavy duty load backrest with a tilt down design to facilitate battery change out.Optional battery rollers provides easier battery change out.



### TRAY

- The optional available tray gives the right place for your work equipment.



### ERGONOMIC ROBUST GERMAN TILLER

- The operator friendly robust metal casted German tiller provides maximum of ergonomics and safety in riding-as well as in walking mode.



### JOG BUTTON

- Job button on the tiller allows operator to walk beside the truck.Additional sidetracker for travelling in tiller direction to increase productivity in order picking operations.The coast mode allows slowly coasting.



## SPECIFICATION

| Feature         | Model                          | 1  | CLG2027L-FL |             | CLG2036L-FL |             |
|-----------------|--------------------------------|----|-------------|-------------|-------------|-------------|
|                 | Poer Type                      | 2  | Electric    |             | Electric    |             |
|                 | Driving Type                   | 3  | Pedestrian  |             | Pedestrian  |             |
|                 | Capacity                       | 4  | kg          | 2700        |             | 3600        |
| Dimension       | Overall Length                 | 5  | mm          | 2330        |             | 3350        |
|                 | Overall Wide                   | 6  | mm          | 1095        |             | 1095        |
|                 | Overall Height                 | 7  | mm          | 880/1550    |             | 880/1550    |
|                 | Min. Height of Fork            | 8  | mm          | 83          |             | 83          |
|                 | Max. Height of Fork            | 9  | mm          | 150         |             | 150         |
|                 | Fork                           | 10 | mm          | 1220×230×60 |             | 2440×255×60 |
|                 | Fork Spread                    | 11 | mm          | 560         | 685         | 585 710     |
|                 | Wheel Base                     | 12 | mm          | 1615        |             | 2130        |
|                 | Turning Radius                 | 13 | mm          | 2145        |             | 2660        |
|                 | Driving Speed (load / unload)  | 14 | km/h        | 11/14       |             | 9.5/12      |
| Performance     | Lifting Speed (load / unload)  | 15 | mm/s        | 38/49       |             | 30/40       |
|                 | Lowering Speed (load / unload) | 16 | mm/s        | 55/50       |             | 45/42       |
|                 | Driving Motor Power            | 17 | kw          | 3.8         |             | 3.8         |
| Motor           | Lifting Motor Power            | 18 | kw          | 2.2         |             | 2.2         |
|                 | Battery Capacity / Voltage     | 19 | Ah/v        | 350 / 24    |             | 350 / 24    |
| Wheel Dimension | Front Wheel                    | 20 | mm          | Φ82×82      |             | Φ82×70      |
|                 | Balance Wheel                  | 21 | mm          | Φ125×60     |             |             |
|                 | Driving Wheel                  | 22 | mm          | Φ310×105    |             |             |
| Weight          | Service Weight                 | 23 | kg          | 1070        |             | 1150        |
|                 | Battery                        | 24 | kg          | 320         |             | 320         |

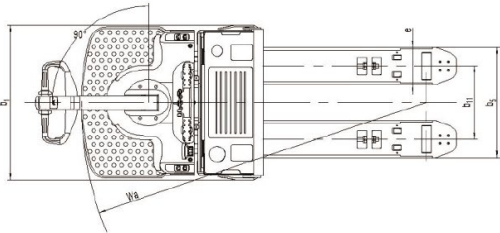
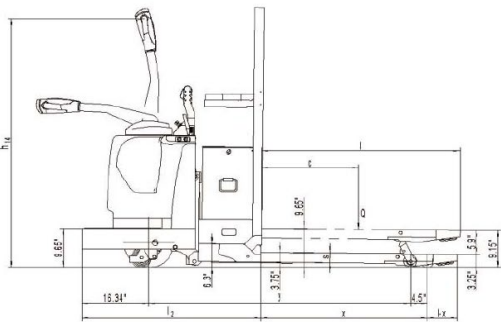

# Electric Pallet Stacker

## Main Features



### BUILT-IN CHARGER

- The built-in charge makes operations more autonomy and increases the operating range.



### ROBUST PROFILE

- Robust mast with real mast profiles for perfect stability,accuracy and high lifetime.



### POWERFUL BATTERY

- 2x12v 85AH powerful VRLA-AGM main-tenance free batteries.
- Option 2x12V 106AH.



### BATTERY DEEP DISCHARGE PROTECTION

- Proofed and ergonomic emergency button and discharge indicator,more robust and reliable than other,The included automatic battery protection ensures high lifetime for the batteries.

### PROOFED COMPONENTS

- Proofed components such as sensors,micro-switches,controller and hydraulic power-pack from international brands.

### FULFILLING STANDARDS

- Fulfilling the actual valid European standards,also in ISO 13849, performance level.

### APPLICATIONS

- Ideal economic solution for all indoor low duty and occasional stacking operations.

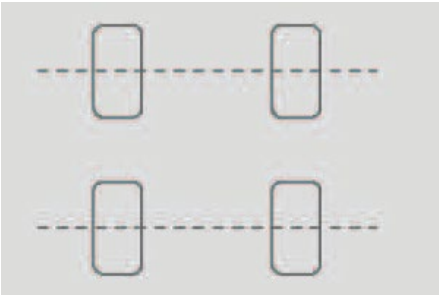

### STABILITY

- 4-Wheel design with sideways tiller for excellent view and maneuverability as well as high stability.



## SPECIFICATION

| Feature         | Model                                       | 1  |      | CLG2S010-WF3 | CLG2S010-WS3          |
|-----------------|---|----|------|--------------|-----------------------|
|                 | Power Type                                  | 2  |      | Electric     | Electric              |
|                 | Driving Type                                | 3  |      | Walking      | Walking, Straddle-leg |
|                 | Capacity                                    | 4  | kg   | 1000         | 1000                  |
| Dimension       | Load Centre                                 | 5  | mm   | 600          | 600                   |
|                 | Overall Length                              | 6  | mm   | 1800         | 1838                  |
|                 | Overall Wide                                | 7  | mm   | 800          | 800 / (1170~1470)     |
|                 | Height of tiller in drive positon min / max | 8  | mm   | 785 / 1300   | 785 / 1300            |
|                 | Lifting Height                              | 9  | mm   | 2900         | 2900                  |
|                 | Max. Height of Truck                        | 10 | mm   | 3325         | 3420                  |
|                 | Full Free Height                            | 11 | mm   | 70           | 70                    |
|                 | Min. Height of Fork                         | 12 | mm   | 85           | 40                    |
|                 | Fork  | 13 | mm   | 1150×150×60  | 1150×100×35           |
|                 | Fork Spread                                 | 14 | mm   | 570/685      | 282~800               |
|                 | Wheel Base                                  | 15 | mm   | 1281         | 1281                  |
|                 | Turning Radius                              | 16 | mm   | 1485         | 1485                  |
| Performance     | Driving Speed (load / unload)               | 17 | km/h | 4.3/4.5      | 4.3/4.5               |
|                 | Lifting Speed (load / unload)               | 18 | mm/s | 110/160      | 110/160               |
|                 | Max. Lowering Speed (load / unload)         | 19 | mm/s | 130/110      | 130/110               |
| Motor           | Driving Motor Power                         | 20 | kw   | 0.45         | 0.45                  |
|                 | Lifting Motor Power                         | 21 | kw   | 2.2          | 2.2                   |
| Wheel Dimension | Battery Capacity / Voltage                  | 22 | Ah/v | 85/ 2×12     | 85/ 2×12              |
|                 | Front Wheel                                 | 23 | mm   | Φ84×70       | Φ84×70                |
|                 | Steering Wheel                              | 24 | mm   | Φ124×60      | Φ124×60               |
|                 | Driving Wheel                               | 25 | mm   | Φ220×70      | Φ220×70               |
| Weight          | Service Weight                              | 26 | kg   | 510          | 756                   |
|                 | Battery                                     | 27 | kg   | 2×25         | 2×25                  |

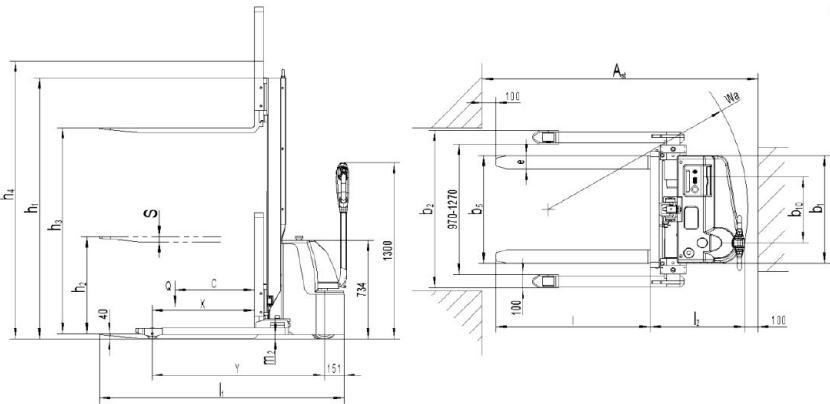



# Electric Pallet Stacker

## Main Features

- The CLG2S012/16/20-WF3 is tailored to most pedestrian controlled stacking operations with capacities from 1200kg up to 2000kg.
- With the long mounted tiller the operator keeps safe and ergonomic distance to perform his work.
- Due to the gentle operating full proportional lifting system stacking operating becomes more safer and quicker.
- With the high-quality and state of the art top-brand components and technologies,the truck competes with leading well-known brands in the market.



### LONG TILLER DESIGN FOR ERGONOMICS AND SAFETY

- In particular through the long tiller design the operator can always keep a safe distance to the truck during proceeding the work very ergonomically.
- The design ensures lowers operational forces than trucks with a short tiller.
- The tiller operating height is naturally positioned to ergonomic,operator friendly controlling positions.
- Specifically staking operations becomes more ergonomically and quicker due to the safe distance and better view to the forks.The 4 wheel design with the sideways long mounted tiller gives particular an exact and perfect view to the forks.



### ELECTRONIC PROPORTIONAL LIFTING AND LOWERING

- The electronically controlled proportional lifting system ensures accurate positioning and stacking operations at every lifting height.
- In specific with high masts the electronic controlled proportional lifting performs at its best.

### CAN-bus

### CANBUS TECHNOLOGY

- the CANBUS technology is due to less wiring more reliable.
- For maintenance the CANBUS technology makes analysis and adjustments easier so that the downtime is lower than for trucks without CANBUS.
- Digital signals further makes parts longer lasting than analogue signals.

## SPECIFICATION

| Feature         | Model  | 1  |      | CLG2S012-WF3 | CLG2S016-WF3 | CLG2S020-WF3 |
|-----------------|--|----|------|--------------|--------------|--------------|
|                 | Power Type                                   | 2  |      | Electric     | Electric     | Electric     |
|                 | Driving Type                                 | 3  |      | Walking      | Walking      | Walking      |
|                 | Capacity                                     | 4  | kg   | 1200         | 1600         | 2000         |
| Dimension       | Load Centre                                  | 5  | mm   | 600          | 600          | 600          |
|                 | Overall Length                               | 6  | mm   | 1919         | 1964         | 2100         |
|                 | Overall Wide                                 | 7  | mm   | 820          | 820          | 820          |
|                 | Height of tiller in drive position min / max | 8  | mm   | 850 / 1385   | 850 / 1385   | 850 / 1385   |
|                 | Lifting Height                               | 9  | mm   | 2900         | 2900         | 2900         |
|                 | Max. Height of Truck                         | 10 | mm   | 3380         | 3380         | 3380         |
|                 | Full Free Height                             | 11 | mm   | 0            | 0            | 0            |
|                 | Min. Height of Fork                          | 12 | mm   | 90           | 90           | 90           |
|                 | Fork   | 13 | mm   | 1150×180×60  | 1150×180×60  | 1150×180×60  |
|                 | Fork Spread                                  | 14 | mm   | 570/685      | 570/685      | 570/685      |
|                 | Wheel Base                                   | 15 | mm   | 1248         | 1293         | 1429         |
|                 | Turning Radius                               | 16 | mm   | 1440         | 1510         | 1640         |
| Performance     | Driving Speed (load / unload)                | 17 | km/h | 6.0/6.0      | 5.7/6.0      | 5.4/6.0      |
|                 | Lifting Speed (load / unload)                | 18 | mm/s | 90/140       | 130/200      | 130/200      |
|                 | Max. Lowering Speed (load / unload)          | 19 | mm/s | 250/200      | 280/230      | 280/230      |
| Motor           | Driving Motor Power                          | 20 | kw   | 1.3          | 1.3          | 1.7          |
|                 | Lifting Motor Power                          | 21 | kw   | 1.5          | 3.2          | 3.2          |
|                 | Battery Capacity / Voltage                   | 22 | Ah/v | 180/24       | 270/24       | 350/24       |
| Wheel Dimension | Front Wheel                                  | 23 | mm   | Φ84×70       | Φ84×70       | Φ84×70       |
|                 | Steering Wheel                               | 24 | mm   | Φ150×54      | Φ150×54      | Φ150×54      |
|                 | Driving Wheel                                | 25 | mm   | Φ230×70      | Φ230×70      | Φ230×70      |
| Weight          | Service Weight                               | 26 | kg   | 1007         | 1340         | 1579         |
|                 | Battery                                      | 27 | kg   | 175          | 230          | 288          |

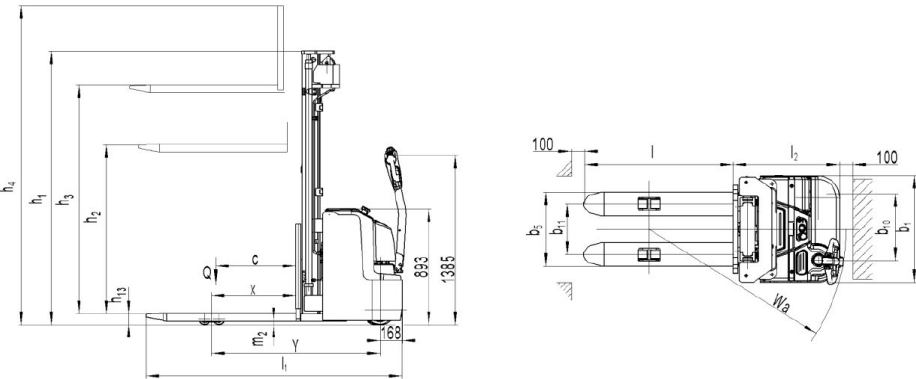

# Straddle-leg Electric Pallet Stacker

## Main Features

- Ergonomic, Compact and safe Long Tiller Design.
- Precise Lifting and Lowering with Full Proportional Hydraulic System.
- Core Components from Top Quality Brands.
- 4 Wheel Structure for Stability.



### LONG TILLER DESIGN FOR ERGONOMICS AND SAFETY

- Specifically stacking operations becomes more ergonomically and quicker due to the safe distance and better view to the forks. The 4 Wheel design with the sideways long mounted tiller gives particular an exact and perfect view to the forks.



### STRADDLE LEG

- Adjustable straddle leg design, suitable for diverse pallet sizes and more stability.



### FOR EVERY APPLICATION THE RIGHT BATTERY CAPACITY

- With the long lasting battery capacities for every model.
- With sideways battery exchange for long operations and multi-shifts.

### ELECTRONIC PROPORTIONAL LIFTING AND LOWERING

- The electronically controlled proportional lifting system ensures accurate positioning and stacking operations at every lifting height.
- In specific with high masts the electronic controlled proportional lifting performs at its best.



## SPECIFICATION

| Feature         | Model  | 1  |      | CLG2S016-WS3          | CLG2S020-WS3          |
|-----------------|--|----|------|-----------------------|-----------------------|
|                 | Power Type                                   | 2  |      | Electric              | Electric              |
|                 | Driving Type                                 | 3  |      | Walking, Straddle-leg | Walking, Straddle-leg |
|                 | Capacity                                     | 4  | kg   | 1600                  | 2000                  |
| Dimension       | Load Centre                                  | 5  | mm   | 600                   | 600                   |
|                 | Overall Length                               | 6  | mm   | 2004                  | 2135                  |
|                 | Overall Wide                                 | 7  | mm   | 820 /(1220~1520)      | 820 /(1220~1520)      |
|                 | Height of tiller in drive position min / max | 8  | mm   | 850 / 1385            | 850 / 1385            |
|                 | Lifting Height                               | 9  | mm   | 2900                  | 2900                  |
|                 | Max. Height of Truck                         | 10 | mm   | 3380                  | 3380                  |
|                 | Full Free Height                             | 11 | mm   | 0                     | 0                     |
|                 | Min. Height of Fork                          | 12 | mm   | 50                    | 50                    |
|                 | Fork   | 13 | mm   | 1150×120×40           | 1150×120×40           |
|                 | Fork Spread                                  | 14 | mm   | 255~730               | 255~730               |
|                 | Wheel Base                                   | 15 | mm   | 1378                  | 1490                  |
|                 | Turning Radius                               | 16 | mm   | 1680                  | 1790                  |
| Performance     | Driving Speed (load / unload)                | 17 | km/h | 5.7/6.0               | 5.4/6.0               |
|                 | Lifting Speed (load / unload)                | 18 | mm/s | 130/200               | 130/200               |
|                 | Max. Lowering Speed (load / unload)          | 19 | mm/s | 200/140               | 200/140               |
| Motor           | Driving Motor Power                          | 20 | kw   | 1.3                   | 1.7                   |
|                 | Lifting Motor Power                          | 21 | kw   | 3.2                   | 3.2                   |
|                 | Battery Capacity / Voltage                   | 22 | Ah/v | 270/24                | 350/24                |
| Wheel Dimension | Front Wheel                                  | 23 | mm   | Φ84×70                | Φ84×70                |
|                 | Steering Wheel                               | 24 | mm   | Φ150×54               | Φ150×54               |
|                 | Driving Wheel                                | 25 | mm   | Φ230×70               | Φ230×70               |
| Weight          | Service Weight                               | 26 | kg   | 1460                  | 1700                  |
|                 | Battery                                      | 27 | kg   | 230                   | 288                   |

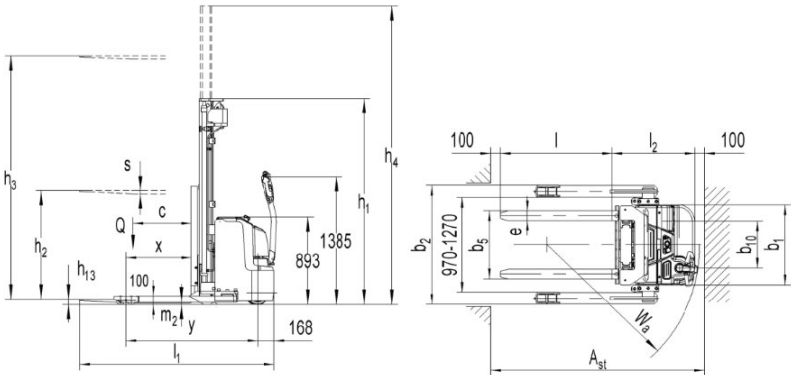



Hand Pallet Truck

Main Features

- Import Seal and chromate-trealed piston rod.
- Easily steering 200°.
- Heavy duty design for moving heavy load.
- Unique hydraulic pump with less effort to lift heavy load easily.
- Conforms to CE safety standard.



SPECIFICATION

| Feature   | Model               |        | 1  |    | CLG2025MJ   | CLG2030MJ   |
|-----------|---------------------|--------|----|----|-------------|-------------|
|           | Power Type          |        | 2  |    | Manual      | Manual      |
|           | Driving Type        |        | 3  |    | Walking     | Walking     |
|           | Capacity            |        | 4  | kg | 2500        | 3000        |
| Dimension | Overall Length      |        | 5  | mm | 1540 / 1630 | 1540 / 1630 |
|           | Overall Wide        |        | 6  | mm | 550 / 685   | 550 / 685   |
|           | Min. Height of Fork |        | 7  | mm | 75          |             |
|           | Max. Height of Fork |        | 8  | mm | 188         |             |
|           | Fork                | Length | 9  | mm | 1150 / 1220 | 1150 / 1220 |
|           |                     | Wide   | 10 | mm | 160         | 160         |
| Weight    | Service Weight      |        | 11 | kg | 65 / 70     | 70 / 75     |

Seated Type Electric Tow Tractor

Main Features

- The appearance of unique,luxury generous.
- Imported AC control technology,excellent performance,reliability,high efficiency,prolong the using time of battery,the longer service life.
- AC motor maintenance free,high speed with high torque output performance,good high speed performance,especially the electric braking performance at high speed.
- Optional EPS electric power steering system for easy to steering.
- Strong climbing ability and traction ability.
- The steering is light and flexible with automatic return.,easy to deal with logistics transport narrow site.
- The tow tractor is simple and convenient to operate, and the driving is smooth and comfortable.

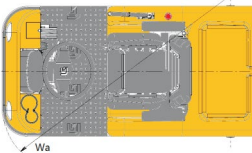
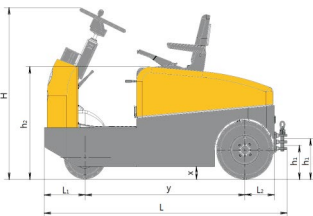

SPECIFICATION

| Feature     | Model                            |  | 1  |      | CLG2020T-TS | CLG2030T-TS | CLG2040T-TS | CLG2050T-TS | CLG2060T-TS |
|-------------|----------------------------------|--|----|------|-------------|-------------|-------------|-------------|-------------|
|             | Power Type                       |  | 2  |      | Electric    | Electric    | Electric    | Electric    | Electric    |
|             | Driving Type                     |  | 3  |      | Seated      | Seated      | Seated      | Seated      | Seated      |
|             | Capacity                         |  | 4  | kg   | 2000        | 3000        | 4000        | 5000        | 6000        |
| Dimension   | Overall Length                   |  | 5  | mm   | 1730        | 1730        | 1880        | 1880        | 1880        |
|             | Overall Wide                     |  | 6  | mm   | 800         | 800         | 800         | 800         | 800         |
|             | Overall Height                   |  | 7  | mm   | 1190        | 1190        | 1190        | 1190        | 1190        |
|             | Wheel Base                       |  | 8  | mm   | 1140        | 1140        | 1290        | 1290        | 1290        |
|             | Rear Overhang                    |  | 9  | mm   | 299         | 299         | 299         | 299         | 299         |
|             | Min. Gound Clearance             |  | 10 | mm   | 80          | 80          | 80          | 80          | 80          |
|             | Turning Radius                   |  | 11 | mm   | 1588        | 1588        | 1748        | 1748        | 1748        |
|             | Min. Right-angle aisle wide      |  | 12 | mm   | 1778        | 1778        | 1938        | 1938        | 1938        |
| Performance | Driving Speed                    |  | 13 | km/s | 8           | 8           | 8           | 8           | 8           |
|             | Max. Gradeability                |  | 14 | %    | 10          | 10          | 10          | 10          | 10          |
| Motor       | Power                            |  | 15 | kw   | 2           | 2           | 4.5         | 4.5         | 4.5         |
|             | Battery Capacity / Voltage       |  | 16 | Ah/v | 165 / 48    | 210 / 48    | 275 / 48    | 300 / 48    | 350 / 48    |
| Weight      | Service Weight (without battery) |  | 17 | kg   | 390         | 395         | 490         | 485         | 495         |
|             | Battery                          |  | 18 | kg   | 350         | 415         | 500         | 525         | 615         |